

# PCTK/PCYK附接头固定式金属配件吸盘

## 形式及订购方法



① ② ③  
PC T K - 5 - K

①真空接口方向

T	纵向接口
Y	横向接口

②吸盘直径 mm

5	φ5	20	φ20
7	φ7	30	φ30
10	φ10	40	φ40
15	φ15	60	φ60
18	φ18	90	φ90

③吸盘橡胶材质

N	丁腈橡胶
S	硅橡胶

注) 上面以外的材质也可以制作, 请与本公司协商。

## 基本型

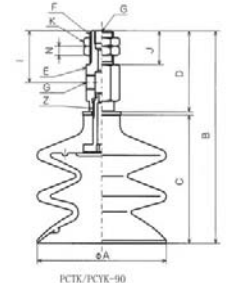
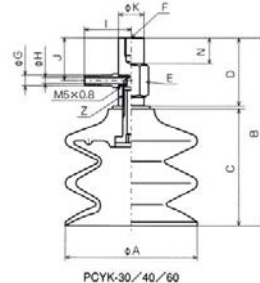
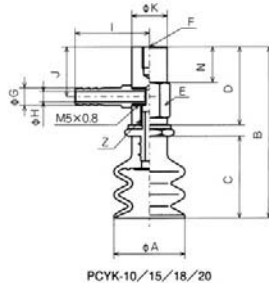
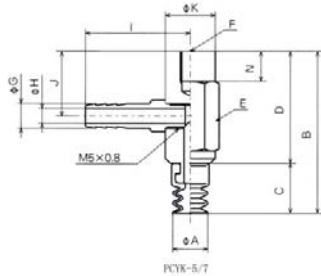
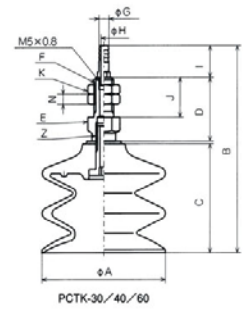
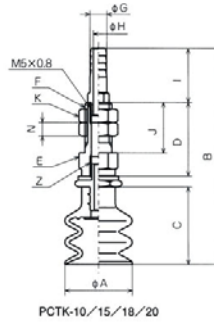
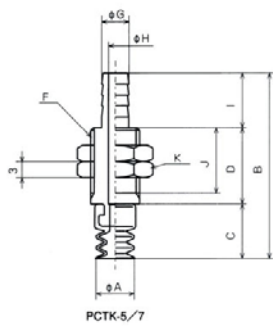

PCTK	A	B	C	D	E	F	G	H	I	J	K	N	Z
PCTK-5	5	33.5	9.5	14	/	M9×1.0	5	2.5	10	12	12H	3	/
PCTK-7	7	34	10	14	/	M9×1.0	5	2.5	10	12	12H	3	/
PCTK-10	10	56.2	15	22	10H	M8×1.25	5	3	16	15	10H	4	M5×0.8
PCTK-15	15	64.2	23	22	10H	M8×1.25	5	3	16	15	10H	4	M5×0.8
PCTK-18	18	64.2	23	22	10H	M8×1.25	5	3	16	15	10H	4	M5×0.8
PCTK-20	20	64.2	23	22	10H	M8×1.25	5	3	16	15	10H	4	M5×0.8
PCTK-30	30	86.8	37.5	32	14H	M10×1.5	5	3	16	20	14H	5	M8×1.25
PCTK-40	40	95.3	46	32	14H	M10×1.5	5	3	16	20	14H	5	M8×1.25
PCTK-60	60	104.3	56	32	14H	M10×1.5	5	3	16	20	14H	5	M8×1.25
PCTK-90	90	144.8	87.5	55	21H	M16×1.5	Rc1/8	/	/	23	21H	6	M12×1.25

PCTK	A	B	C	D	E	F	G	H	I	J	K	N	Z
PCTK-5	5	32	9.5	22.5	/	M4深6	5	3	21	13	10	6	/
PCTK-7	7	32.5	10	22.5	/	M4深6	5	3	21	13	10	6	/
PCTK-10	10	40.2	15	22	10H	M4深7	5	3	21	14	10	10	M5×0.8
PCTK-15	15	48.2	23	22	10H	M4深7	5	3	21	14	10	10	M5×0.8
PCTK-18	18	48.2	23	22	10H	M4深7	5	3	21	14	10	10	M5×0.8
PCTK-20	20	48.2	23	22	10H	M4深7	5	3	21	14	10	10	M5×0.8
PCTK-30	30	70.8	37.5	32	14H	M6深8	5	3	23	20	12	12	M8×1.25
PCTK-40	40	79.3	46	32	14H	M6深8	5	3	23	20	12	12	M8×1.25
PCTK-60	60	88.3	56	32	14H	M6深8	5	3	23	20	12	12	M8×1.25
PCTK-90	90	144.8	87.5	55	21H	M16×1.5	Rc1/8	/	35	23	21H	6	M12×1.25